



Adresse / Address

Datum / Date

Kontakt / Contact

June 2011

Ledermann GmbH & Co. KG
Willi-Ledermann-Str. 1
D-72160 Horb a.N.

Tel. +49 (0) 74 51 / 93 - 0
info@leuco.com
www.leuco.com

Betreff / Subject

Seite / Page

LEUCO TRIBOS – The clamping system for maximum performance

01/02

Inhalt / Content

In terms of CNC-processing, maximum performance means high RPM, high feed rates and perfect quality. Thanks to its high concentricity, the power shrink-fit chuck LEUCO Tribos is the ideal clamping system in the high-end range.

As an interface between machine and tool the clamping system LEUCO Tribos creates an exact connection between the tool and the machine and thus stands for high concentricity. Thanks to the low weight and no own unbalance the LEUCO Tribos is characterized by extremely low vibration.

The slim-design clamping system has an optimal constraining contour which allows work even in zones difficult to access. In combination with extensions there are practically no limits.

[LEUCO clamping system construction kit see back side].

Machine / Application

- | CNC machining centers with automatic tool changer
- | for precise clamping of shank-type tools with cylindrical shank

Design

- | $n_{max} = 40.000$ U/min
- | for right- and lefthand rotation

Advantages

- | low weight is easy on machine bearing
- | suitable for high RPM's
- | optimum chip extraction thanks to slim design
- | increased process safety, long edge lives and high machining quality thanks to very high concentricity and repeating accuracy (< 0.003 mm)

Bildmaterial / Imagery

LEUCO TRIBOS



Tribos power shrink-fit chuck HSK 63 with HSK shank

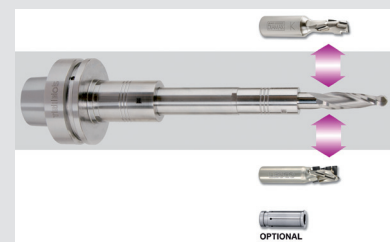

Flexible use of shank-type cutters thanks to the Tribos extension

Functional principle of the power shrink-fit chuck

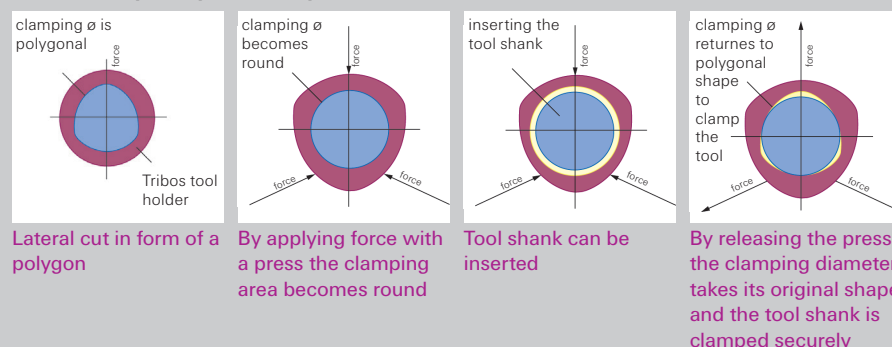

LEUCO

www.leuco.com



Adresse / Address

Datum / Date

Kontakt / Contact

June 2011

Ledermann GmbH & Co. KG
Willi-Ledermann-Str. 1
D-72160 Horb a.N.

Tel. +49 (0) 74 51 / 93 - 0
info@leuco.com
www.leuco.com

Betreff / Subject

Seite / Page

LEUCO TRIBOS – The clamping system for maximum performance

02/02

Inhalt / Content

Bildmaterial / Imagery

Program LEUCO TRIBOS HSK

Ø d1min	L2	Ø d	Ø D	L1	a	x	weight	Ident-No.
12	48,5	HSK 63F	19	100	75	18	0,69	180257
16	48,5	HSK 63F	26	100	75	18	0,74	180899
20	52,9	HSK 63F	30	100	75	18	0,77	180258
25	55	HSK 63F	35	100	75	18	0,79	180710
[mm]	[mm]	[mm]	[mm]	[mm]	[mm]	[mm]	[kg]	

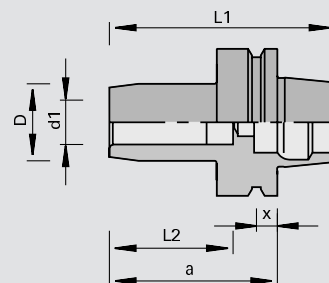

Program LEUCO Tribos SK-Shank

Ø d1min	L2	Ø d	Ø D	L1	a	Ident-No.
20	55	SK 30 (DIN)	30	127	80	180888
25	55	SK 30 (DIN)	35	127	80	180836
[mm]	[mm]	[mm]	[mm]	[mm]	[mm]	

Program modular clamping systems: LEUCO TRIBOS extensions

Ø d1min	L2	Ø d	L1	Ident-No.
6	27	20	100	182800 o
8	27	20	100	182801 o
10	32	20	100	182802 o
12	37	20	100	182803 o
6	27	20	150	182804 o
8	27	20	150	182805 o
10	32	20	150	182806 o
12	37	20	150	182807 o
6	27	20	250	182808 o
8	27	20	250	182809 o
10	32	20	250	182810 o
12	37	20	250	182811 o
[mm]	[mm]	[mm]	[mm]	

